

Triq Testaferrata

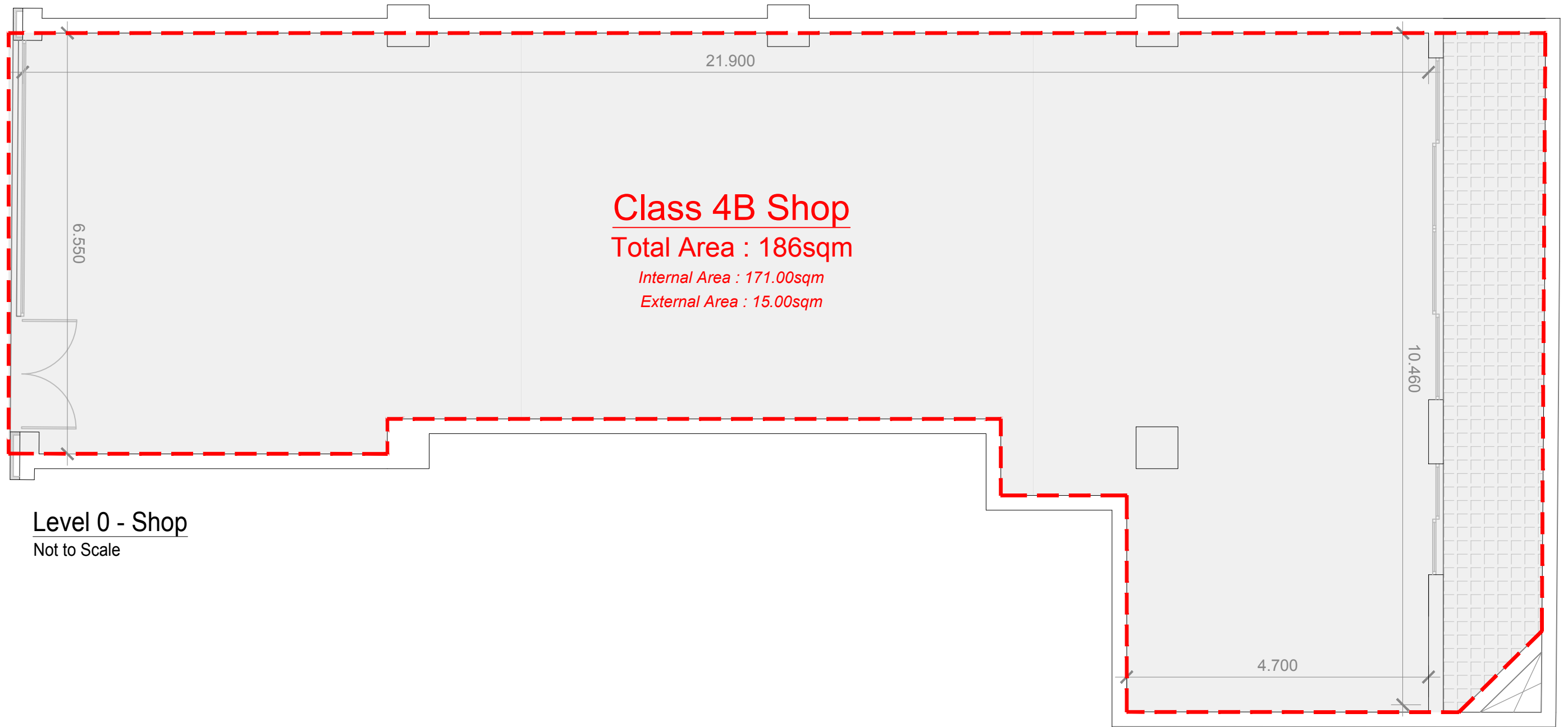

Class 4B Shop
Total Area : 186sqm
Internal Area : 171.00sqm
External Area : 15.00sqm

Level 0 - Shop
Not to Scale

APPROVED
DEVELOPMENT · LEASING · HOSPITALITY

CLIENT

PROJECT

Forth Business Centre

SITE LOCATION

Testaferrata Street,
Ta' Xbiex

DESCRIPTION

Floor Area Calculation

SHEET NO. DRAWING

01 G01.PROP01

SCALE: Not to Scale

DRAWN BY: SV 12.02.2026

CHECKED BY: